



interlift
LYFT- & MATERIALHANTERING

Magneter FX LIFT

LYFTDON | TELFRAR | TRAVERSER | KRANAR | VINSCHAR | LYFTBORD | LYFTVAGNAR | **PLÅTHANTERING**

Exclusive Benefits of the FX-Series

FX - Economically the right decision

- Made in Germany
- Standard-compliant and tested
CE/EN 13155/MRL 2006/42 EWG
- Product liability insurance with a German insurance company
- Multilingual Documentation
- Environmentally friendly and future-proof by higher Power with lower SE Magnet consumption
- **3 years Warranty**
- Safety factor **3,5**
- supply of spare parts guaranteed for **10 years**
- CAD Data available
- Facilitated document management for work safety

FX - Technically the right decision

- 100% nickel
- High Energy half-shell Magnets
- actuator travel of only 90°
- large forged lifting eye (SF5)
- great performance in a compact design
- short loading- and unloading times
- no mechanical impairment of workpiece
- very massive shift shaft
- recoilless hand operation
- suitable for flat and round materials
- increased safety via simple operation

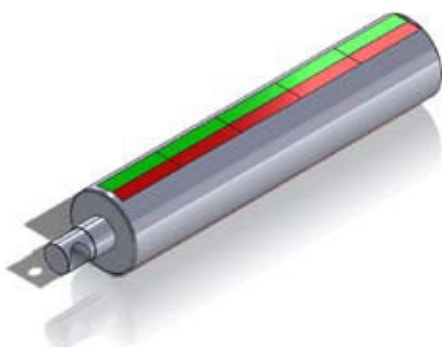
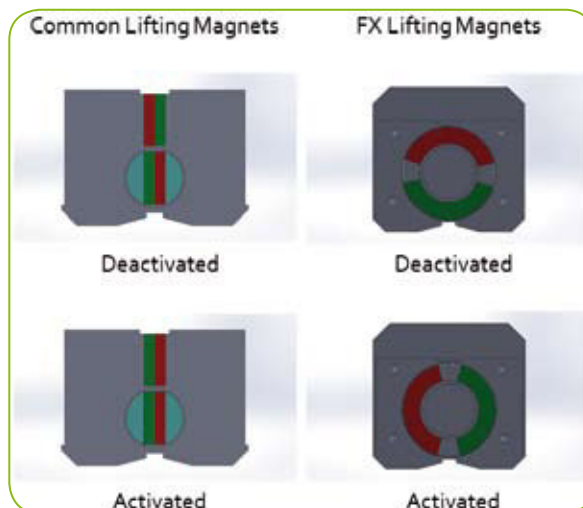
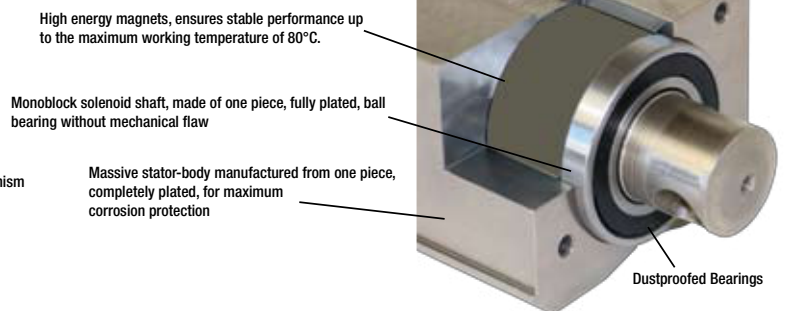
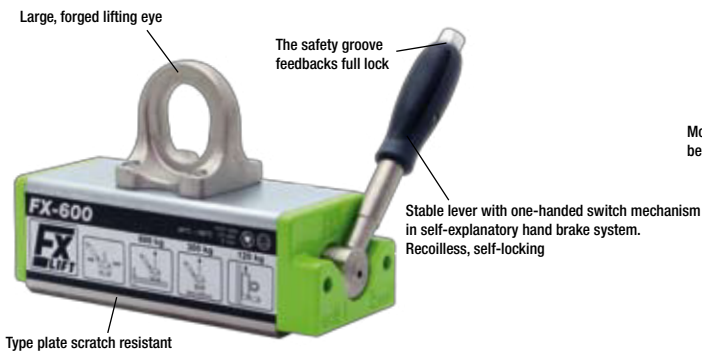

Common Lifting Magnets

Recessed or welded shifter shaft with Built-in magnets, 180° theoretical switching travel, Weakened or welded shaft, 3 air gaps

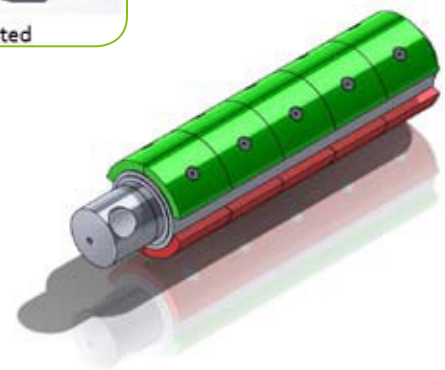

FX Lifting Magnets

Massive switching shaft with mounted magnets, 90° theoretical switching travel, extremely robust, Only one air gap

FX Universal Permanent Lifting Magnets

FX lifting magnets in standard version convince with their wide range of applications. The FX achieved good results at both, a large air gap as well as thin flat and round materials. It has a compact design and low weight. The device is characterized by great robustness and a very good price/performance ratio.

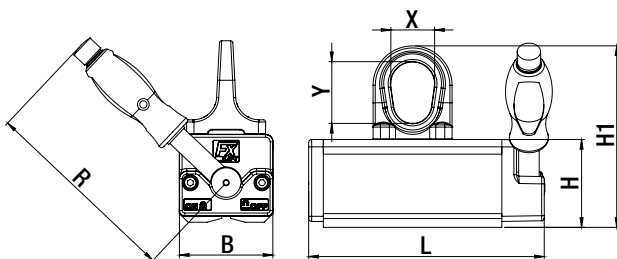

Model	Item-Nr.	Max. Load capacity (kg)		Max. Load capacity from (mm)	Dimensions (mm)						Weight (kg)
		flat	round		L	B	H	H1	R	X/Y	
FX-150	1101 0150	150 kg	Ø50-200 mm 75 kg	8	161	64	60	124	136	30/42	3,6
FX-300	1101 0300	300 kg	Ø50-300 mm 150 kg	15	205	87	78	158	190	42/53	8,4
FX-600	1101 0600	600 kg	Ø80-400 mm 300 kg	20	288	112	94	189	228	51/62	19
FX-1000	1101 1000	1000 kg	Ø100-450 mm 500 kg	25	361	152	120	240	261	60/76	42
FX-2000	1101 2000	2000 kg	Ø120-600 mm 1000 kg	50	472	228	169	313	409	68/89	115
FX-3000	1101 3000	3000 kg	Ø250-600 mm 1500 kg	50	648	228	169	313	534	68/89	166

Safety factor 3,5/Test method EN 13155
max. Operation temperature 80°C • Load charts and Safety from Page 40

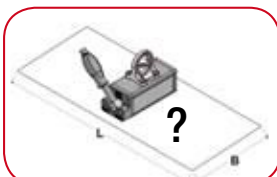

Load Charts and Safety from Page 40

FX-R Permanent Lifting Magnets especially suitable for Round Material

FX-R is the lifting magnet series for round material handling. The deep flat angle prism ensures safe positioning on the load and directs the magnetic field deep into the material. The magnet system can be switched good in the entire Diameter. It does not snap back, shearing off the load by turning is prevented by a cross prism.

Sheet, even with low material thickness, is no problem for the FX-R. On hot workpieces, the deep prism protects the magnetic core from overheating.

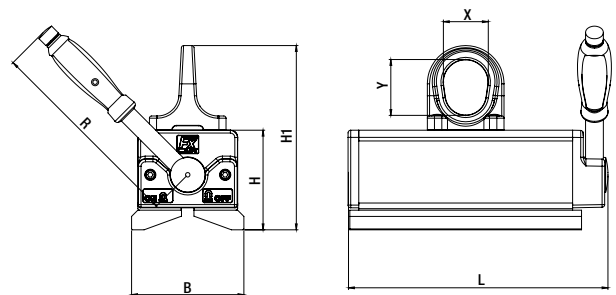
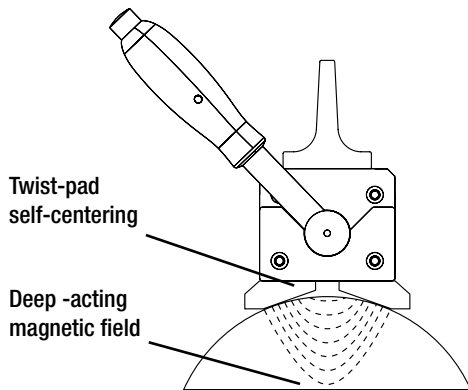

Model	Item-Nr.	Max. Load capacity (kg)		Max. Load capacity from (mm)	Dimensions (mm)							Weight (kg)
		flat	round		L	B	H	H1	R	X/Y		
FX-R100	1101 0101	100	Ø 25-150 mm 100 kg	8	161	70	68	132	136	30/42	4	
FX-R225	1101 0221	225	Ø 50-205 mm 225 kg	10	205	98	90	170	190	42/53	9,5	
FX-R450	1101 0451	450	Ø 50-270 mm 450 kg	20	288	126	112	207	228	51/62	22	
FX-R750	1101 0751	750	Ø 70-370 mm 750 kg	20	361	170	142	262	261	60/76	49	
FX-R1200	1101 1201	1200	Ø 120-560 mm 1200 kg	40	472	248	190	334	409	68/89	127	
FX-R1800	1101 1801	1800	Ø 120-560 mm 1800 kg	40	648	248	190	334	534	68/89	182	

Safety factor 3,5/Test method EN 13155
max. Operation temperature 80°C • Load charts and Safety from Page 40

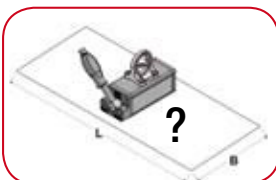

Load Charts and Safety from Page 40

FX-P Permanent Lifting Magnets especially for thin sheets and pipes

FX-P is the lifting magnet series for professional lifting and moving of thinner sheets, tubes and bars. The special Magnet-Configuration in conjunction with the prismatic pole of the FX-P ensures maximum flux density even on thin material thickness.

The FX-P can be positioned well on round tube and gently pressed.

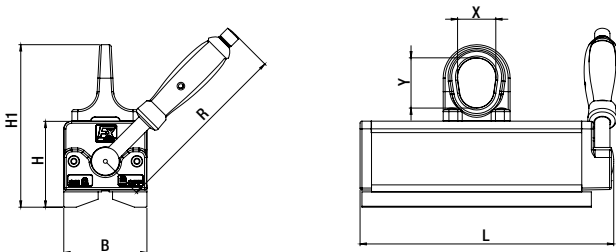

For thin sheet

Model	Max. Load capacity at sheets and 4-edge pipes						Pipes and rods		
	3mm	4mm	6mm	8mm	10mm	15mm	LxB max.	Ø kg	L Ømm
FX-P170	50	80	120	170	170	170	2000x1250	150	30-105
FX-P330	70	100	160	300	330	330	2500x1250	300	40-160
FX-P650	100	160	200	450	530	650	3000x1500	550	60-210

Model	Item-Nr.	Max. Load capacity (kg)		Max. Load capacity from (mm)	Dimensions (mm)						Weight (kg)
		flat	round		L	B	H	H1	R	X/Y	
FX-P170	1101 0172	170 kg	Ø 30-105 mm 150 kg	8	195	64	70	134	136	30/42	5,1
FX-P330	1101 0332	330 kg	Ø 40-160 mm 300 kg	10	265	87	90	170	190	42/53	12,4
FX-P650	1101 0652	650 kg	Ø 60-210 mm 550 kg	20	352	112	108	203	228	51/62	26

Safety factor 3,5/Test method EN 13155
max. Operation temperature 80°C • Load charts and Safety from Page 40

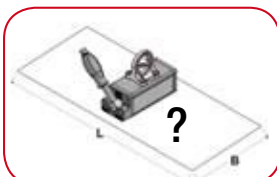

Load Charts and Safety from Page 40

FX-V Permanent Lifting Magnets with 90° Prism for beams, Profiles and hot parts

FX-V Lifting magnets are specifically tailored to the areas of application in the steel, shipbuilding and container construction. They have a long, narrow design for receiving carriers and Profiles - also on the inner web of the beam - and reach its maximum holding power so that even thin sheets can be lifted safely even at comparatively low material thickness. Thanks to the 90° prism, angle profiles can securely be received or components are turned. When lifting hot internal cuts, the deep prism protects the built-in magnets from heat.

The FX-V, like all FX models, has a completely nickel-plated magnetic body and provides very good test results, even in rough surfaces. Also the FX-V has a stable smooth one-hand switch.



150°C/100%

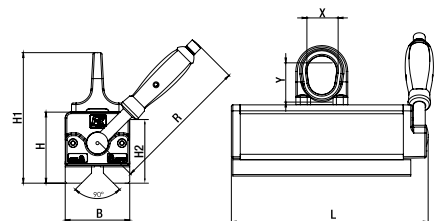

Model	Item-Nr.	Max. Load capacity (kg)			Max. Load capacity from (mm)	Dimensions (mm)						Weight (kg)
		flat	round	90°		L	B	H	H1	R	X/Y	
FX-V200	1101 0203	200 kg	∅ 20-50 mm 100 kg	120 kg	10	195	64	77	141	134	30/42	5,5
FX-V400	1101 0403	400 kg	∅ 25-60 mm 200 kg	250 kg	15	265	87	96	176	188	42/53	13
FX-V800	1101 0803	800 kg	∅ 35-75 mm 300 kg	400 kg	20	352	112	115	210	228	51/62	28

Safety factor 3,5/Test method EN 13155
max. Operation temperature 150°C • Load charts and Safety from Page 40

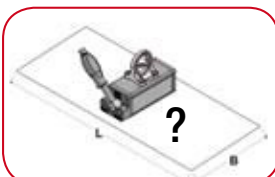

Load Charts and Safety from Page 40

FX-HV Horizontal-Vertical Systems

The FX-HV Horizontal-Vertical System will meet with its diverse setting almost any need. Overall height and focus can be adjusted by plug pins. Likewise, the device also can be used for up to 20% of its rated load without engaging under pads. The support pins are positioned in a way so that standing blanks can be struck, which, for example, is often required on the saw.

Likewise lying discs and sheets can be placed. For horizontal transport, the system has a lifting eye on the back. The steel structure is completely coated, and the stable FX Lifting magnet ensures maximum safety. Special dimensions are available on request.

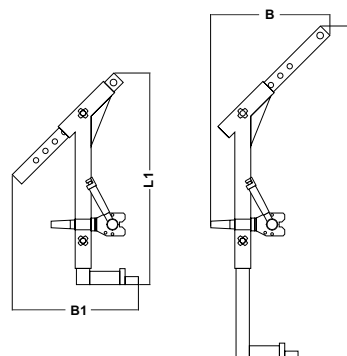

Model	Item-Nr.	Slices-Ø (mm)	Flat material Dimensions (mm)	Max. Load capacity with stop (kg)	Max. Load capacity without stop (kg)	Dimensions (mm)				Weight (kg)
						L	B	L1	B1	
FX-HV 200	1103 0202	250 - 750	2000 x 750	200	40	1000	400	715	390	24
FX-HV 400	1103 0402	400 - 1000	2000 x 1000	400	80	1250	450	795	475	31
FX-HV 800	1103 0802	500 - 1200	2500 x 1250	800	160	1500	500	1040	520	64
FX-HV 2000	1103 2002	500 - 1200	2500 x 1250	2000	400	1800	600	1200	650	272
FX-HV 3000	1103 3002	500 - 1200	2500 x 1250	3000	600	1800	600	1200	650	321

max. Operation temperature 80°C • Weight incl. Magnet

Towing Eye for FX Lifting Magnets

Special option "towing-eyelet" for FX lifting magnets. For vertical transport of lighter parts FX lifting magnets can come with an extra towing-eyelet.



Model	Item-Nr.	Max. towing capacity (kg)
FX-150 Towing Eye	8 1101 0001	25
FX-300 Towing Eye	8 1101 0002	60
FX-600 Towing Eye	8 1101 0003	120
FX-1000 Towing Eye	8 1101 0004	200



FX-HV 3000 for up to 3.000kg



FX-HV 200-S Special Version

FX-LT Permanent Magnetic Truss

FX-LT magnet trusses adapted to the needs of metal fabricators, laser and flame cutters. Two FX-V Lifting magnets and a slight distance truss with 2-strain chain allows the loading and unloading of machines with sheets, or the horizontal Pick up of workpieces with center cutout. With a few simple steps the magnets can be removed from the crossbar to lift blanks and small plates with only one magnet.

Delivery includes:

- 2 Lifting magnets
- 2-strain chain with hooks and eyelets
- Distance truss with suspension elements



Quick detachable for single use

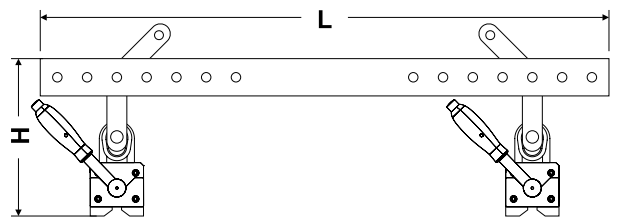

Model	Item-Nr.	incl. 2x FX	Max. Load (kg)	capacity from (mm)	Max. Workpiece Dimensions (mm)	Dimensions (mm)		Weight (kg)
						L	H	
FX-LT700	1104 0700	FX-V400	700	15	5000 x 1500	1600	270	44
FX-LT1000	1104 1000	FX-600	1000	20	5000 x 1500	1600	291	58
FX-LT1400	1104 1400	FX-V800	1400	20	5000 x 2000	1600	360	86
FX-LT3200	1104 3200	FX-2000	3200	50	5000 x 2500	2000	480	305
FX-LT4800	1104 4800	FX-3000	4800	50	5000 x 2500	2000	600	410

FX-LT Permanent Magnetic Truss



FX-LT700

Material thickness (mm)	Max. Dimensions (mm)		Max. Load (kg)
	L (max)	B (max)	
≥ 4	3000	1500	180
≥ 6	3500	1500	260
≥ 8	4000	1500	490
≥ 10	4500	1500	610
≥ 15	5000	1500	700

FX-LT1000

Material thickness (mm)	Max. Dimensions (mm)		Max. Load (kg)
	L (max)	B (max)	
≥ 4	3000	1500	180
≥ 6	3000	1500	250
≥ 8	4000	1500	300
≥ 10	4500	1500	500
≥ 15	4500	1500	820
≥ 20	5000	1500	1000

FX-LT1400

Material thickness (mm)	Max. Dimensions (mm)		Max. Load (kg)
	L (max)	B (max)	
≥ 4	3000	1500	180
≥ 6	3000	2000	350
≥ 8	4000	2000	700
≥ 10	4500	2000	800
≥ 15	5000	2000	1130
≥ 20	5000	2000	1400

FX-LT3200

Material thickness (mm)	Max. Dimensions (mm)		Max. Load (kg)
	L (max)	B (max)	
≥ 15	4000	2000	800
≥ 20	5000	2000	1600
≥ 25	5000	2000	1920
≥ 40	5000	2500	2560
≥ 50	5000	2500	3200

FX-LT4800

Material thickness (mm)	Max. Dimensions (mm)		Max. Load (kg)
	L (max)	B (max)	
≥ 15	5000	2000	1200
≥ 20	5000	2000	2400
≥ 25	5000	2500	2880
≥ 40	5000	2500	3840
≥ 50	5000	2500	4800

FX-KT Small Trusses

FX-KT Small Trusses are adapted to the needs of sheet metalworkers, laser and flame cutters. Two FX magnets and one adjustable small bar allow the transport of workpieces with a central cutout. In particular, rings and cylindrical workpieces with a central cut can be transported efficiently and effortlessly with the FX-KT.

In a few simple steps, the magnets can be removed from the crossbar to lift blanks and small plates with only one magnet.

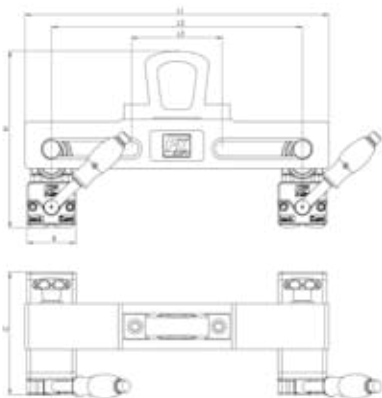

Model	Item-Nr.	Max. Load (kg)	Capacity from (mm)	Dimensions (mm)						Magnetic adjustment inner edge-inner edge (mm)	Weight (kg)
				L1	L2	L3	B	C	H		
FX-KT 240-260	1105 0240-260	240	8	400	330	120	64	161	233	58-260	15
FX-KT 240-420	1105 0240-420	240	8	560	484	120	64	161	233	58-420	15
FX-KT 240-470	1105 0240-470	240	8	607	537	120	64	161	233	58-470	20
FX-KT 240-540	1105 0240-540	240	8	680	603	120	64	161	233	58-540	22
FX-KT 480-440	1105 0480-440	480	15	620	504	150	87	205	269	65-440	26
FX-KT 480-600	1105 0480-600	480	15	800	690	150	87	205	269	65-600	30
FX-KT 480-800	1105 0480-800	480	15	1000	887	150	87	205	286	65-800	32

Permanent Lifting Magnets in Special Versions

Permanent lifting magnets are manufactured with the most different special-pole-pieces and as load spreader for almost all geometries. We manufacture magnets for spherical surfaces, with long pole pieces, for rings and sleeves and profiles. All special Lifting magnets are constructed, tested and documented in accordance with EN 13155 and MD 2006/42 EEC.





MBX Magnetic Clamping Blocks

MBX magnetic clamping blocks have opposite clamping sides which are activated when actuated. They are designed to clamp workpieces on steel surfaces such as machine or assembly tables.

A number of MBXs can also be connected to each other via the hexagonal shank of the switching shaft in order to clamp longer or larger workpieces.

The activation is effected via the detachable switch wrench with only 90° switching travel, the surfaces of the MBX are completely nickel-plated.

With the two differently shaped clamping sides of the MBX almost any workpiece geometry can be held, regardless of whether round material, sheets or even profiles are to be clamped.



The MBX magnetic clamping block stretches itself on the table and tension the workpiece



MBX are the optimal clamping tool for welding, deburring or welding Tapping quickly, flexibly and without stress.



Suitable for drilling, grinding, welding ... even vertical!



Suitable for angle material



Suitable for Round material

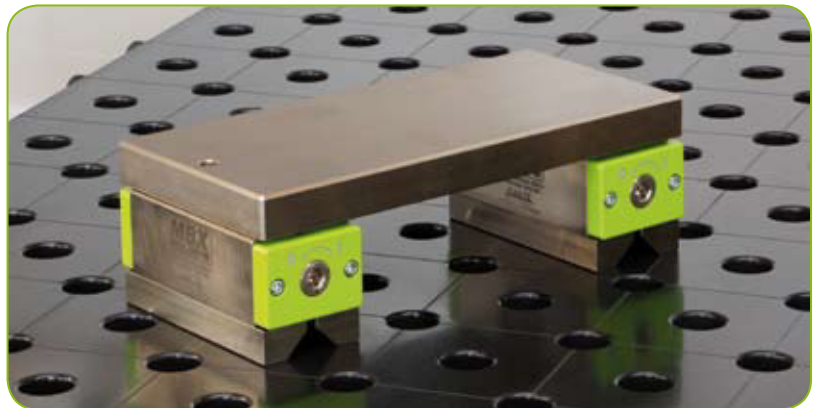

Suitable for Flat material



Tip: The 90° poles of the MBX can be replaced with workpiece-specific poles



Tip: Multiple MBX can be switched at the same time

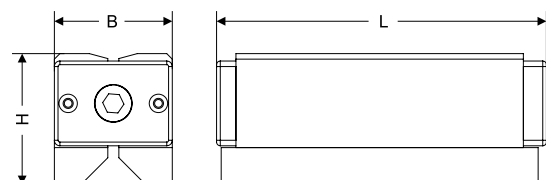

Model	Item-Nr.	Dimension (mm)			Surface 1 (mm) (Flat + Round)	Surface 2 (mm) (Flat + 90°)	System holding Power (kN)	Weight (kg)
		L	B	H				
MBX 5	3002 005	143	64	71	120 x 57	136 x 64	5	3,9
MBX 5 Pair	3002 005-1	143	64	71	120 x 57	136 x 64	5	2x3,9
MBX 7	3002 007	178	64	71	156 x 57	172 x 64	7	4,9
MBX 7 Pair	3002 007-1	178	64	71	156 x 57	172 x 64	7	2x4,9
MBX 10	3002 010	184	87	88	162 x 76	178 x 87	10	8,8
MBX 10 Pair	3002 010-1	184	87	88	162 x 76	178 x 87	10	2x8,8

FX Force / Load / Air Gap

FX 150	Air gap < 0,1mm			Air gap 0,1 - 0,3 mm			Air gap 0,3 - 0,5 mm		
Material thickness (mm)	Max. Load (kg)	Max. L (mm)	Max. W (mm)	Max. Load (kg)	Max. L (mm)	Max. W (mm)	Max. Load (kg)	Max. L (mm)	Max. W (mm)
>= 2	20	800	800	12	800	800	10	800	800
>= 4	60	1500	1000	40	1500	1000	30	1200	1000
>= 6	80	1500	1000	60	1500	1000	50	1200	1000
>= 8	150	1500	1000	120	1500	1000	80	1200	1000
Ø50-200	75	1500	1000	50	2000	-	40	1500	-

FX 300	Air gap < 0,2mm			Air gap 0,2 - 0,3 mm			Air gap 0,3 - 0,6 mm		
Material thickness (mm)	Max. Load (kg)	Max. L (mm)	Max. W (mm)	Max. Load (kg)	Max. L (mm)	Max. W (mm)	Max. Load (kg)	Max. L (mm)	Max. W (mm)
>= 4	60	1600	1000	50	1500	1000	40	1250	1000
>= 8	200	2000	1250	160	2000	1250	120	1500	1000
>= 10	230	2250	1250	190	2000	1250	150	1500	1000
>= 15	300	2500	1250	250	2000	1250	200	1500	1000
Ø50-300	150	3000	-	125	2500	-	100	2000	-

FX 600	Air gap < 0,2mm			Air gap 0,2 - 0,3 mm			Air gap 0,3 - 0,6 mm		
Material thickness (mm)	Max. Load (kg)	Max. L (mm)	Max. W (mm)	Max. Load (kg)	Max. L (mm)	Max. W (mm)	Max. Load (kg)	Max. L (mm)	Max. W (mm)
>= 6	150	1800	1500	120	1800	1250	100	1500	1250
>= 10	300	2250	1500	250	2250	1250	210	2000	1250
>= 15	500	2500	1500	440	2500	1250	350	2000	1250
>= 20	600	3000	1500	520	3000	1250	440	2500	1250
Ø80-400	300	4000	-	250	3500	-	200	3000	-

FX 1000	Air gap < 0,3mm			Air gap 0,3 - 0,5 mm			Air gap 0,5 - 0,6 mm		
Material thickness (mm)	Max. Load (kg)	Max. L (mm)	Max. W (mm)	Max. Load (kg)	Max. L (mm)	Max. W (mm)	Max. Load (kg)	Max. L (mm)	Max. W (mm)
>= 10	350	2250	1500	300	2250	1500	260	2250	1250
>= 15	600	2500	1500	500	2500	1500	450	2500	1250
>= 20	900	3000	1500	750	3000	1500	675	3000	1250
>= 25	1000	3500	1500	850	3000	1500	750	3000	1250
Ø100-450	500	4500	-	400	4000	-	330	3000	-

FX 2000	Air gap < 0,3mm			Air gap 0,3 - 0,6 mm			Air gap 0,6 - 0,8 mm		
Material thickness (mm)	Max. Load (kg)	Max. L (mm)	Max. W (mm)	Max. Load (kg)	Max. L (mm)	Max. W (mm)	Max. Load (kg)	Max. L (mm)	Max. W (mm)
>= 15	500	2500	2000	400	3000	2000	330	2500	1500
>= 25	1200	3000	2000	950	3000	2000	800	3000	1500
>= 40	1600	2500	2000	1300	3000	2000	1100	3000	1500
>= 50	2000	4000	2000	1600	3000	2000	1300	3000	1500
Ø120-600	1000	4500	-	800	4000	-	650	3500	-

FX 3000	Air gap < 0,3mm			Air gap 0,3 - 0,6 mm			Air gap 0,6 - 0,8 mm		
Material thickness (mm)	Max. Load (kg)	Max. L (mm)	Max. W (mm)	Max. Load (kg)	Max. L (mm)	Max. W (mm)	Max. Load (kg)	Max. L (mm)	Max. W (mm)
>= 15	750	2500	2500	600	3000	2500	500	2500	2000
>= 25	1800	3000	2500	1400	3000	2500	1200	3000	2000
>= 40	2400	3500	2500	2000	3000	2500	1600	3000	2000
>= 50	3000	4000	2500	2400	3000	2500	2000	3000	2000
Ø120-600	1500	5000	-	1200	5000	-	1000	4000	-

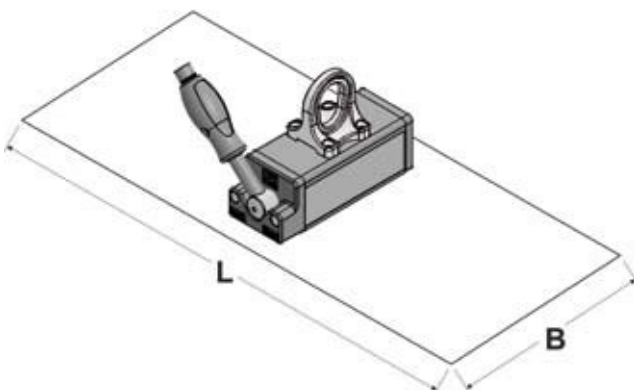

FX-R Force / Load / Air Gap

FX-R100	Air gap < 0,1mm			Air gap 0,1 - 0,3 mm			Air gap 0,3 - 0,5 mm		
Material thickness (mm)	Max. Load (kg)	Max. L (mm)	Max. W (mm)	Max. Load (kg)	Max. L (mm)	Max. W (mm)	Max. Load (kg)	Max. L (mm)	Max. W (mm)
≥ 2	25	800	800	12	800	800	10	800	800
≥ 4	50	1500	1000	40	1500	1000	30	1200	1000
≥ 6	70	1500	1000	60	1500	1000	45	1200	1000
≥ 8	100	1500	1000	75	1500	1000	60	1200	1000
Ø25-150	100	2000	-	75	2000	-	60	1500	-

FX-R225	Air gap < 0,2mm			Air gap 0,2 - 0,3 mm			Air gap 0,3 - 0,6 mm		
Material thickness (mm)	Max. Load (kg)	Max. L (mm)	Max. W (mm)	Max. Load (kg)	Max. L (mm)	Max. W (mm)	Max. Load (kg)	Max. L (mm)	Max. W (mm)
≥ 4	80	1600	1000	60	1500	1000	40	1250	1000
≥ 8	180	2000	1250	150	2000	1250	120	1500	1250
≥ 10	225	2250	1250	200	2000	1250	150	1500	1250
Ø50-205	225	3000	-	200	2500	-	150	2000	-

FX-R450	Air gap < 0,2mm			Air gap 0,2 - 0,3 mm			Air gap 0,3 - 0,6 mm		
Material thickness (mm)	Max. Load (kg)	Max. L (mm)	Max. W (mm)	Max. Load (kg)	Max. L (mm)	Max. W (mm)	Max. Load (kg)	Max. L (mm)	Max. W (mm)
≥ 6	150	1800	1500	120	1800	1000	100	1500	1250
≥ 10	300	2250	1500	250	2250	1250	210	2000	1250
≥ 15	400	2500	1500	350	2500	1250	300	2000	1250
≥ 20	450	3000	1500	400	3000	1250	350	2500	1250
Ø50-270	450	4000	-	375	3500	-	280	3000	-

FX-R750	Air gap < 0,3mm			Air gap 0,3 - 0,5 mm			Air gap 0,5 - 0,6 mm		
Material thickness (mm)	Max. Load (kg)	Max. L (mm)	Max. W (mm)	Max. Load (kg)	Max. L (mm)	Max. W (mm)	Max. Load (kg)	Max. L (mm)	Max. W (mm)
≥ 8	300	2250	1500	280	2250	1500	250	2250	1250
≥ 10	400	2500	1500	380	2500	1500	300	2500	1250
≥ 15	700	3000	1500	680	3000	1500	550	3000	1250
≥ 20	750	3500	1500	720	3000	1500	600	3000	1250
Ø70-370	750	4500	-	600	4000	-	450	3000	-

FX-R1200	Air gap < 0,3mm			Air gap 0,3 - 0,6 mm			Air gap 0,6 - 0,8 mm		
Material thickness (mm)	Max. Load (kg)	Max. L (mm)	Max. W (mm)	Max. Load (kg)	Max. L (mm)	Max. W (mm)	Max. Load (kg)	Max. L (mm)	Max. W (mm)
≥ 15	600	2500	2000	500	3000	2000	440	2500	1500
≥ 20	800	3000	2000	650	3000	2000	550	3000	1500
≥ 25	1000	3500	2000	800	3000	2000	700	3000	1500
≥ 40	1200	4000	2000	1000	3000	2000	900	3000	1500
Ø120-560	1200	4500	-	900	4000	-	700	3500	-

FX-R1800	Air gap < 0,3mm			Air gap 0,3 - 0,6 mm			Air gap 0,6 - 0,8 mm		
Material thickness (mm)	Max. Load (kg)	Max. L (mm)	Max. W (mm)	Max. Load (kg)	Max. L (mm)	Max. W (mm)	Max. Load (kg)	Max. L (mm)	Max. W (mm)
≥ 15	900	2500	2000	750	3000	2000	660	2500	1500
≥ 20	1200	3000	2000	1000	3000	2000	825	3000	1500
≥ 25	1500	3500	2000	1200	3000	2000	1050	3000	1500
≥ 40	1800	4000	2000	1500	3000	2000	1200	3000	1500
Ø120-560	1800	5000	-	1500	4000	-	1125	3500	-

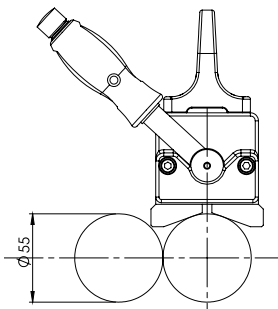

FX-R100

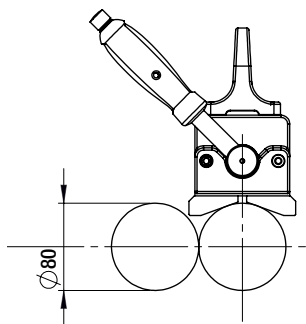

FX-R225

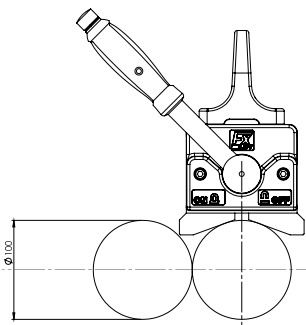

FX-R450

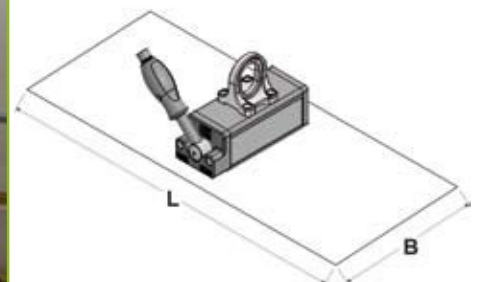
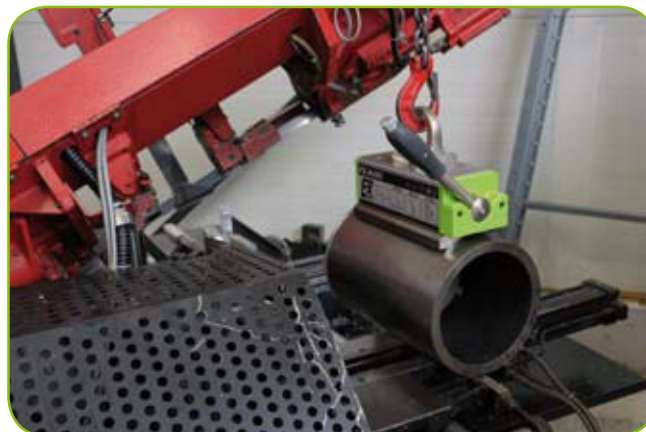

FX-P Force / Load / Air Gap

FX-P170	Air gap < 0,1mm			Air gap 0,1 - 0,3 mm			Air gap 0,3 - 0,5 mm		
Material thickness (mm)	Max. Load (kg)	Max. L (mm)	Max. W (mm)	Max. Load (kg)	Max. L (mm)	Max. W (mm)	Max. Load (kg)	Max. L (mm)	Max. W (mm)
>= 2	30	800	800	20	800	800	15	800	800
>= 4	80	1500	1250	60	1500	1250	50	1200	1250
>= 6	120	1500	1250	90	1500	1250	75	1200	1250
>= 8	170	1500	1250	130	1500	1250	100	1200	1250
Ø30-105	150	2000	-	115	2000	-	60	1500	-

FX-P330	Air gap < 0,2mm			Air gap 0,2 - 0,3 mm			Air gap 0,3 - 0,6 mm		
Material thickness (mm)	Max. Load (kg)	Max. L (mm)	Max. W (mm)	Max. Load (kg)	Max. L (mm)	Max. W (mm)	Max. Load (kg)	Max. L (mm)	Max. W (mm)
>= 4	100	2000	1250	80	1500	1250	60	1250	1250
>= 6	160	2500	1500	130	2000	1500	100	1500	1500
>= 8	300	2500	1500	240	2000	1500	180	1500	1500
>= 10	330	2500	1500	330	2000	1500	200	1500	1500
Ø40-160	300	3500	-	250	3000	-	180	2500	-

FX-P650	Air gap < 0,2mm			Air gap 0,2 - 0,3 mm			Air gap 0,3 - 0,6 mm		
Material thickness (mm)	Max. Load (kg)	Max. L (mm)	Max. W (mm)	Max. Load (kg)	Max. L (mm)	Max. W (mm)	Max. Load (kg)	Max. L (mm)	Max. W (mm)
>= 4	160	2250	1500	130	2000	1500	110	2000	1500
>= 6	200	2500	1500	175	2250	1500	140	2250	1500
>= 8	450	3000	1500	400	3000	1500	320	2500	1500
>= 10	550	2500	1500	500	3000	1500	400	2500	1500
>= 20	650	3000	1500	570	3000	1500	450	2500	1500
Ø60-210	550	4000	-	480	3500	-	400	3000	-

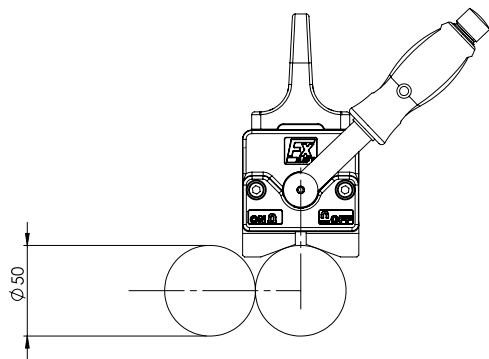

FX-P170

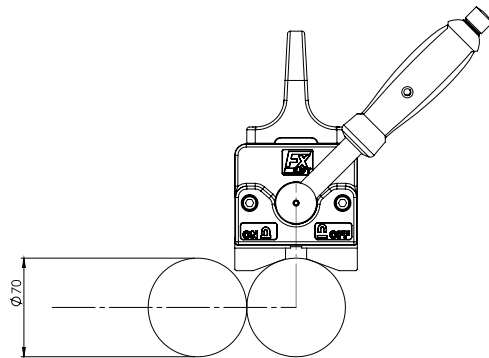

FX-P330

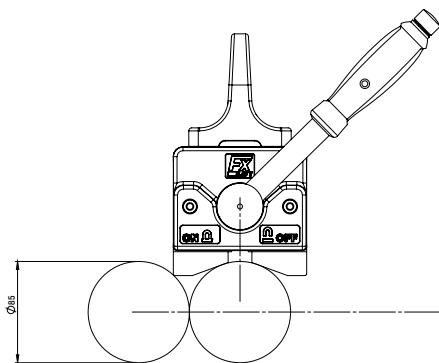

FX-P650

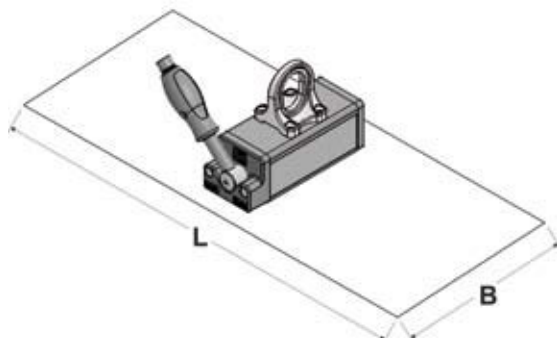

FX-V Force / Load / Air Gap

FX-V200	Air gap < 0,1mm			Air gap 0,1 - 0,3 mm			Air gap 0,3 - 0,5 mm		
Material thickness (mm)	Max. Load (kg)	Max. L (mm)	Max. W (mm)	Max. Load (kg)	Max. L (mm)	Max. W (mm)	Max. Load (kg)	Max. L (mm)	Max. W (mm)
>= 4	70	1500	1250	50	1500	1250	35	1000	1250
>= 6	110	2000	1250	75	1500	1250	60	1250	1250
>= 8	175	2500	1250	120	2000	1250	90	2000	1250
>= 10	200	2500	1250	140	2000	1250	110	2000	1250
Ø20-50	100	2000	-	70	2000	-	60	1500	-
90°	120	2000	-	90	2000	-	60	1500	-

FX-V400	Air gap < 0,2mm			Air gap 0,2 - 0,3 mm			Air gap 0,3 - 0,6 mm		
Material thickness (mm)	Max. Load (kg)	Max. L (mm)	Max. W (mm)	Max. Load (kg)	Max. L (mm)	Max. W (mm)	Max. Load (kg)	Max. L (mm)	Max. W (mm)
>= 6	150	2000	1000	110	1500	1000	75	1250	1000
>= 8	280	2500	1250	210	2250	1250	150	2000	1250
>= 10	350	2500	1250	260	2250	1250	180	2000	1250
>= 15	400	2500	1250	290	2250	1250	220	2000	1250
Ø70-370	200	3500	-	160	2250	-	120	2500	-
90°	250	3500	-	190	3000	-	130	2500	-

FX-V800	Air gap < 0,2mm			Air gap 0,2 - 0,3 mm			Air gap 0,3 - 0,6 mm		
Material thickness (mm)	Max. Load (kg)	Max. L (mm)	Max. W (mm)	Max. Load (kg)	Max. L (mm)	Max. W (mm)	Max. Load (kg)	Max. L (mm)	Max. W (mm)
>= 4	130	2000	1500	100	2000	1500	90	2000	1500
>= 6	200	2500	1500	160	2250	1500	130	2250	1500
>= 8	400	3000	1500	320	3000	1500	270	2500	1500
>= 15	650	3000	1500	520	3000	1500	420	2500	1500
>= 20	800	3000	1500	650	3000	1500	550	2500	1500
Ø35-75	300	4000	-	240	3500	-	200	3000	-
90°	400	4000	-	320	3500	-	300	3000	-

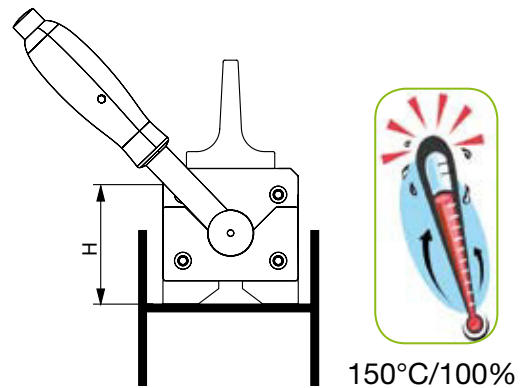
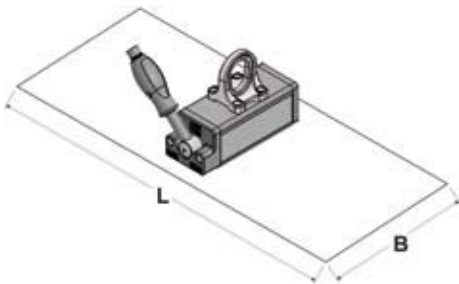

FX-V	H2 (mm)	IPE	HEB
FX-V 200	65	from IPE 80	from HEB 100
FX-V 400	87	from IPE 100	from HEB 120
FX-V 800	106	from IPE 140	from HEB 160

Interlift AB

Interlift AB har sedan starten 1994 förstärkt och breddat sitt produktsortiment inom lyft- och materialhantering.

Högsta kvalitet och hög säkerhet är viktigt inom all lyftverksamhet och självklart både för oss och våra leverantörer.

Med lång och gedigen erfarenhet i kombination med viljan att alltid vara lätt tillgängliga, är vår fortsatta strävan att vara ditt bästa val.

Vänd dig med förtroende till Interlift – ett starkt val när det gäller lyft- och materialhantering!

Service och reparationer

Vi utför service, reparationer, registerhållning och besiktning av alla lyftdon, oavsett fabrikat.



Getinggränd 2 · 275 39 Sjöbo

Bronsyxegatan 9B · 213 75 Malmö

Tel 010 -188 22 00 · Mail info@interlift.se

VÅR SAMLADE ERFARENHET INOM LYFT- OCH MATERIALHANTERING STÅR TILL DITT FÖRFOGANDE OCH VI ÄR ALDRIG LÄNGRE BORT ÄN DIN NÄRMSTA TELEFON.